

AFCO Installation & Operation Instructions

Model #AF 976901 • Sentry Spray Dispenser (Floor Mount)

REQUIREMENTS

Dimensions

Total Height	44 in.
Height to Spray Head	42 in.

Dispenses per Gallon	Adjustable
----------------------	------------

OPTIONS

Stainless Steel Jug Racks

Jug Rack, SS, 1 Gallon, Round/Square	# 224200
Jug Rack, SS, 1 Gallon, Round/Square (Locking)	# 224200-L

Lid & Suction Hose for 1 & 5 Gallon Pails

Pail Lid Suction Hose Assembly	# 709101
--------------------------------	----------

WEIGHT & DIMENSIONS

Shipping Weight: 31 lbs.

Shipping Dimensions: 11" x 11" x 46"



<http://www.afcocare.com>

**READ ALL
INSTRUCTIONS BEFORE
USING EQUIPMENT!**

Overview

The Sentry Spray Dispenser is an all stainless steel free-standing hand sanitizer or soap dispenser that is designed to encourage sanitary environments by reducing contamination due to hand contact. The Sentry is designed to pump liquid or low viscosity products. When the foot pedal is pressed, this industrial strength system draws a set amount of ready-to-use chemical and dispenses it directly into the users hand. Perfect for dispensing hand sanitizer in food preparation areas, hospitals, retail store entrances and other public areas.



Safety & Operational Precautions

- Manufacturer assumes no liability for the use or misuse of this unit.
- Follow the chemical manufacturer's safe handling instructions.

TO INSTALL (REFER TO DIAGRAM, NEXT PAGE.)

1. Floor-mounted units can be either free-standing, on a non-skid mat, for portability or bolted to the floor for permanent positioning.
2. Immerse the suction tube with suction strainer into sanitizing solution.
3. Raise the container of sanitizing solution so that it is level with the discharge nozzle.
4. Prime the unit by repeatedly stepping on the foot pedal until it begins to spray. Initial priming may take several strokes, particularly if a gel or thick sanitizing solution is being used.
5. Once primed, place the container of sanitizing solution in the (optional) jug rack.
6. Adjust number of dispenses with the "adjustment bolt", using the locking nut to hold it in place. Tighten for less dispenses per gallon and loosen for more dispenses per gallon.

TO OPERATE

1. Place hands under nozzle and step on the foot pedal.

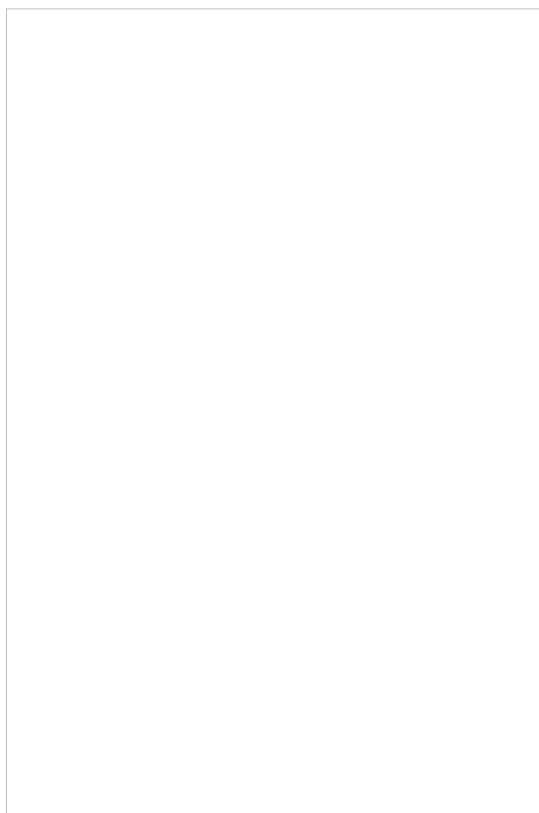

Phillips Screwdriver
Required to Loosen
Screws and Lift Cover

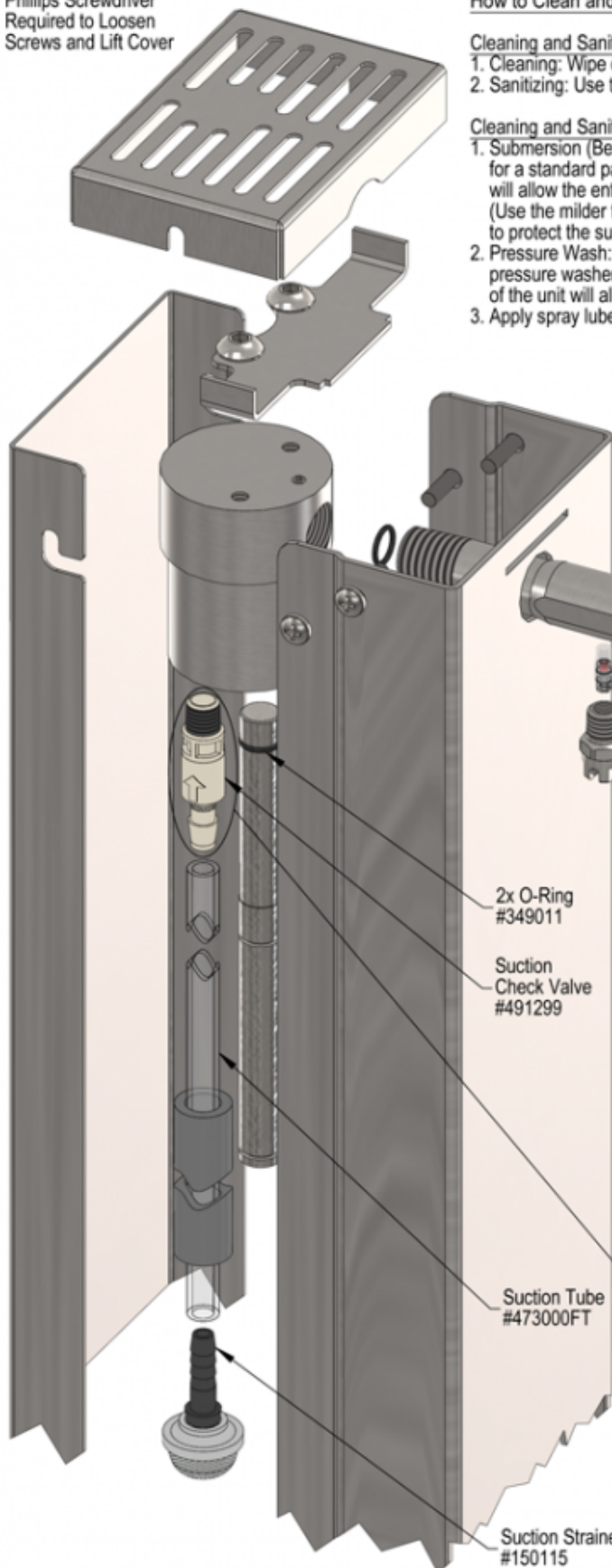

How to Clean and Sanitize the Sentry Spray Dispenser:

Cleaning and Sanitizing External Surface Only:

1. Cleaning: Wipe down or pressure wash external parts with a mild stainless steel cleaner.
2. Sanitizing: Use the same sanitizers that are used on stainless and plastic surfaces.

Cleaning and Sanitizing Both Internally and Externally:

1. Submersion (Best Method): Submerge entire assembly into a COP (Clean Out of Place) vat for a standard parts cleaning procedure. The openings in the top and bottom of the Sentry will allow the entire assembly to circulate and sanitize in the standard COP procedure. (Use the milder type cleaning solutions safe for EPDM and stainless steel at less than 125°F to protect the suction tube. Standard COP filler parts cleaning procedure will apply.)
2. Pressure Wash: If no COP tank is available the unit can be cleaned using a standard pressure washer (1500 psi or less). The openings in the top and the bottom of the unit will allow access to the internal parts.
3. Apply spray lube to working parts in the lower assembly.

Chemical Path Cleaning and Sanitizing:

1. Rinse the old solution from the tubing and nozzle with clear water.
2. Fill the sanitizer reservoir with hand sanitizer solution and pump the solution through. The suction tubing should be changed on a yearly basis or when the tubing shows signs of chemical attack. Tubing can become stiff due to leeching of the plasticizers from the tubing, but this does not affect the function of the Sentry. Other tubing can be substituted that more closely matches the chemistry being used.

Sentry Nozzle Assembly
(Includes Check Valve)
#708120

To Clean Debris from Nozzle & Check Valve

1. Use the end of the tubing to unscrew the check valve from the nozzle.
2. To remove debris from check ball, blow compressed air in this direction ONLY! (With no more than 5psi)

3. Check nozzle for debris before reinstalling check valve. To reassemble, use the end of the tubing to carefully screw the check valve back into the nozzle, until the red poppit is showing slightly past the nozzle.

4. If Suction Check Valve is ever to be replaced, be sure to wrap a small amount of Teflon tape around the threads before installation, with care not to allow any tape into the fluid stream.

Sentry Spray System Rebuild Kit
(Includes all wetted parts and spare O-ring)
976900-KIT

Troubleshooting Guide

AF 976901 • Sentry Spray Dispenser (Floor Mount)

Problem	Possible Cause / Solution	
	Startup	Maintenance
A) Will not draw sanitizer.	1, 2	3, 6, 8, 9, 10, 11
B) Using too little sanitizer.	3, 5	7, 10
C) Using too much sanitizer.	4, 5	
D) Dispenses inconsistent amount of sanitizer.	5	10

Possible Cause / Solution	
Startup	Maintenance
<ol style="list-style-type: none"> 1. The unit needs to be primed. <ul style="list-style-type: none"> ◦ Step on foot pedal repeatedly until it sprays. 2. Chemical tube not immersed in sanitizer solution or sanitizer depleted. <ul style="list-style-type: none"> ◦ Immerse tube or replenish. 3. The Adjustment Bolt needs to be loosened. 4. The Adjustment Bolt needs to be tightened. 5. The Locking Nut needs to be tightened. 	<ol style="list-style-type: none"> 6. Suction check valve or nozzle check valve stuck or failed. <ul style="list-style-type: none"> ◦ Clean or replace. 7. Foot valve / strainer partially blocked. <ul style="list-style-type: none"> ◦ Clean or replace foot valve / strainer. 8. Chemical tube stretched out or pin hole/cut in tube (sucking in air). <ul style="list-style-type: none"> ◦ Cut off end of tube or replace tube. 9. Vacuum leak in chemical pick-up connections. <ul style="list-style-type: none"> ◦ Tighten the connection. 10. Chemical build-up may have formed in the head of the unit. <ul style="list-style-type: none"> ◦ Follow Preventive maintenance instructions below, using hot water and/or descaling acid. 11. O-ring may have worn down after prolonged use. <ul style="list-style-type: none"> ◦ Replace.

When the unit will be out of service for extended periods, remove tube and place in water. Operate the foot pedal until water is coming out of the nozzle for several seconds to clear out chemical and help prevent chemical build-up. Check chemical strainer and clean or replace as needed.

